

MAD-S

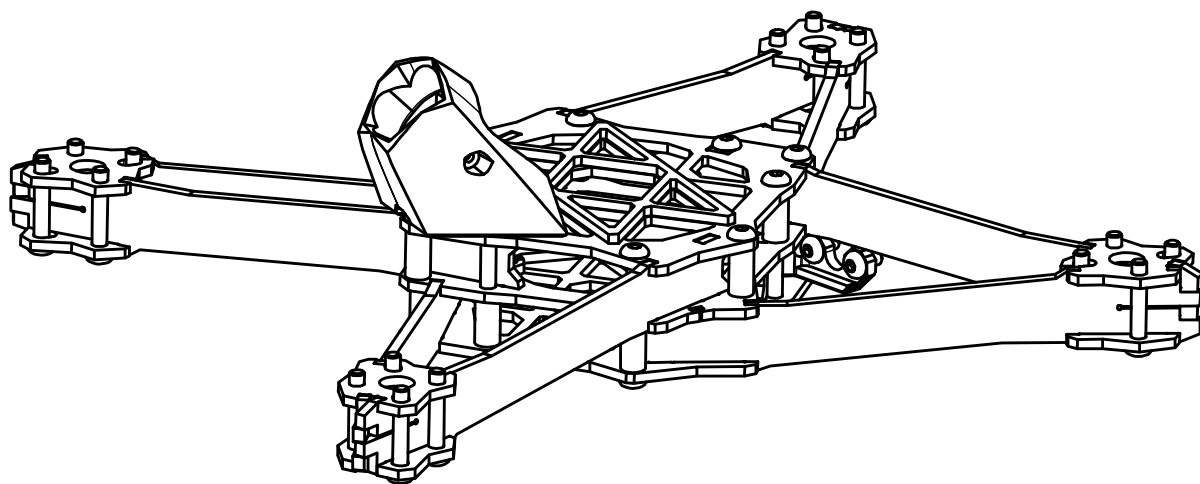

MADKWADS

Parts included in MAD-S frame kit

Scale 1:2

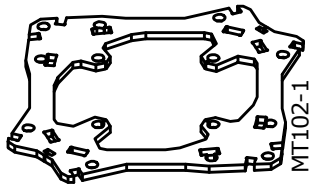

Center Plate
1x

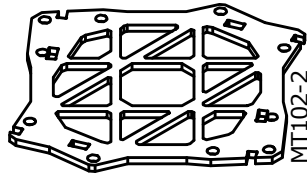

Top/Bottom Plate
2x



Arm
8x



Motor plate
8x

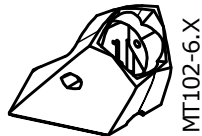

Camera mount
1x



Antenna bracket
1x

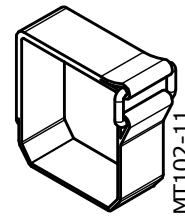

Battery strap
2x

Scale 2:1



Button Head
Screw
10x



Button Head
Screw
1x

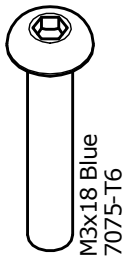

Button Head
Screw
25x

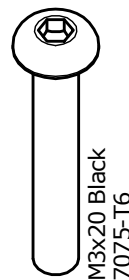

Button Head
Screw
1x

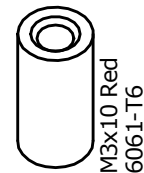

Female
Standoff
10x

MAD-S can be assembled in a several ways. What's best for you depends on your motors hole-pattern. If you follow this instruction the motor cables will be aligned with the arm going to the top level where the ESC is recommended to be mounted. Using motors with 16x16 hole-pattern let you build according to Mode A **OR** Mode B, depending on what gives you best access to the flight controller USB connector

Mode A

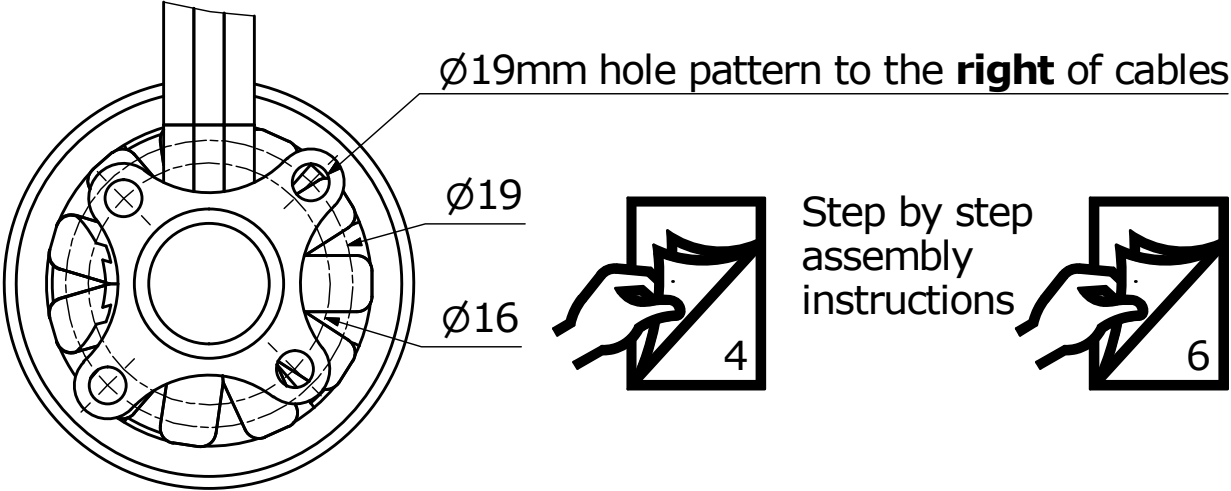

Mode B

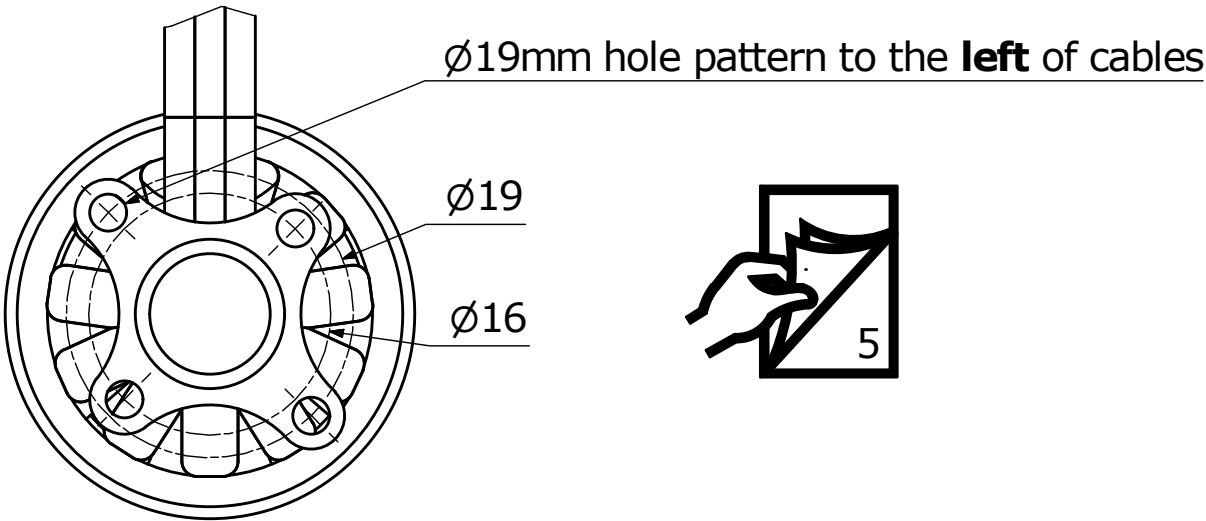

Mode A

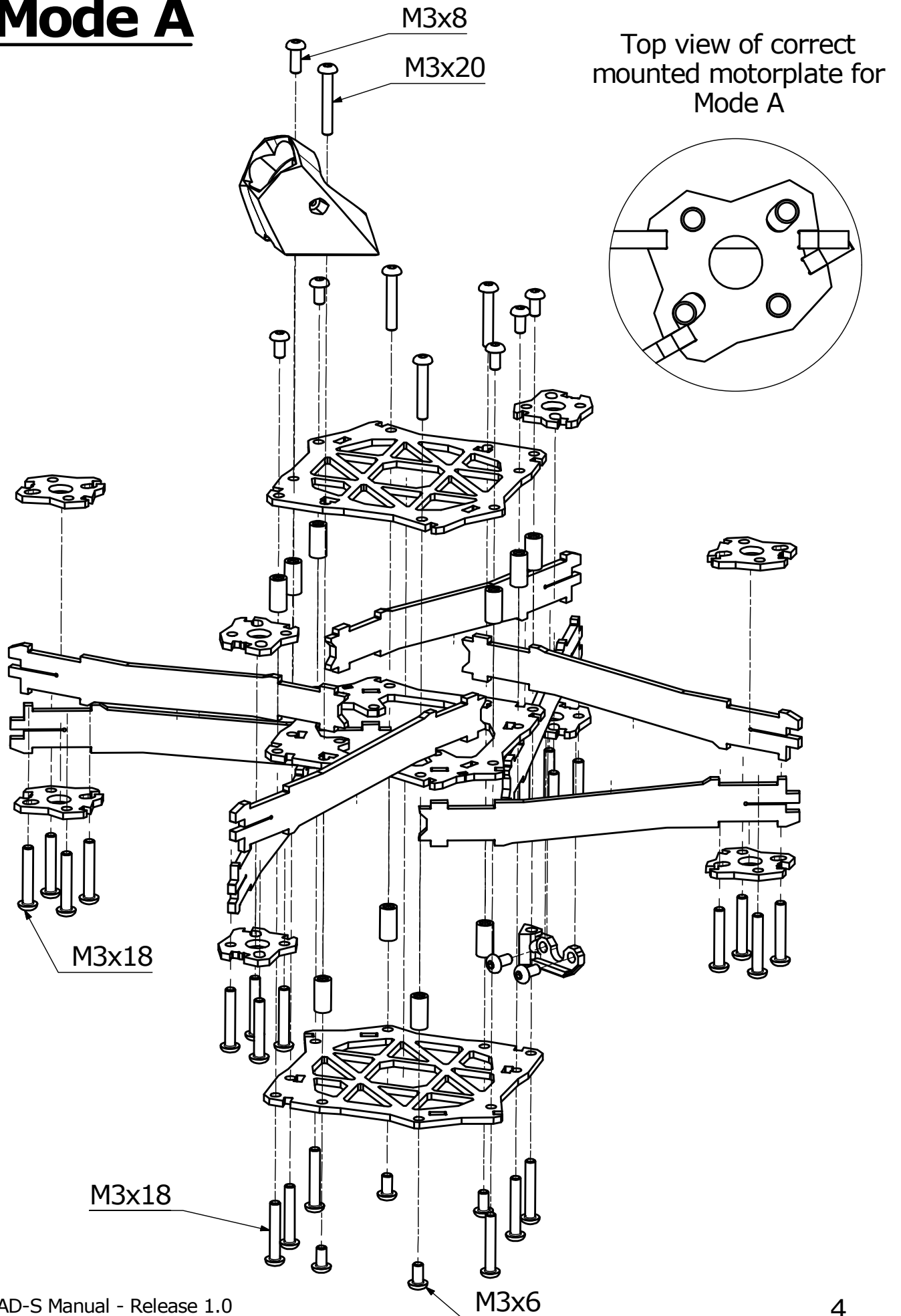

Mode B

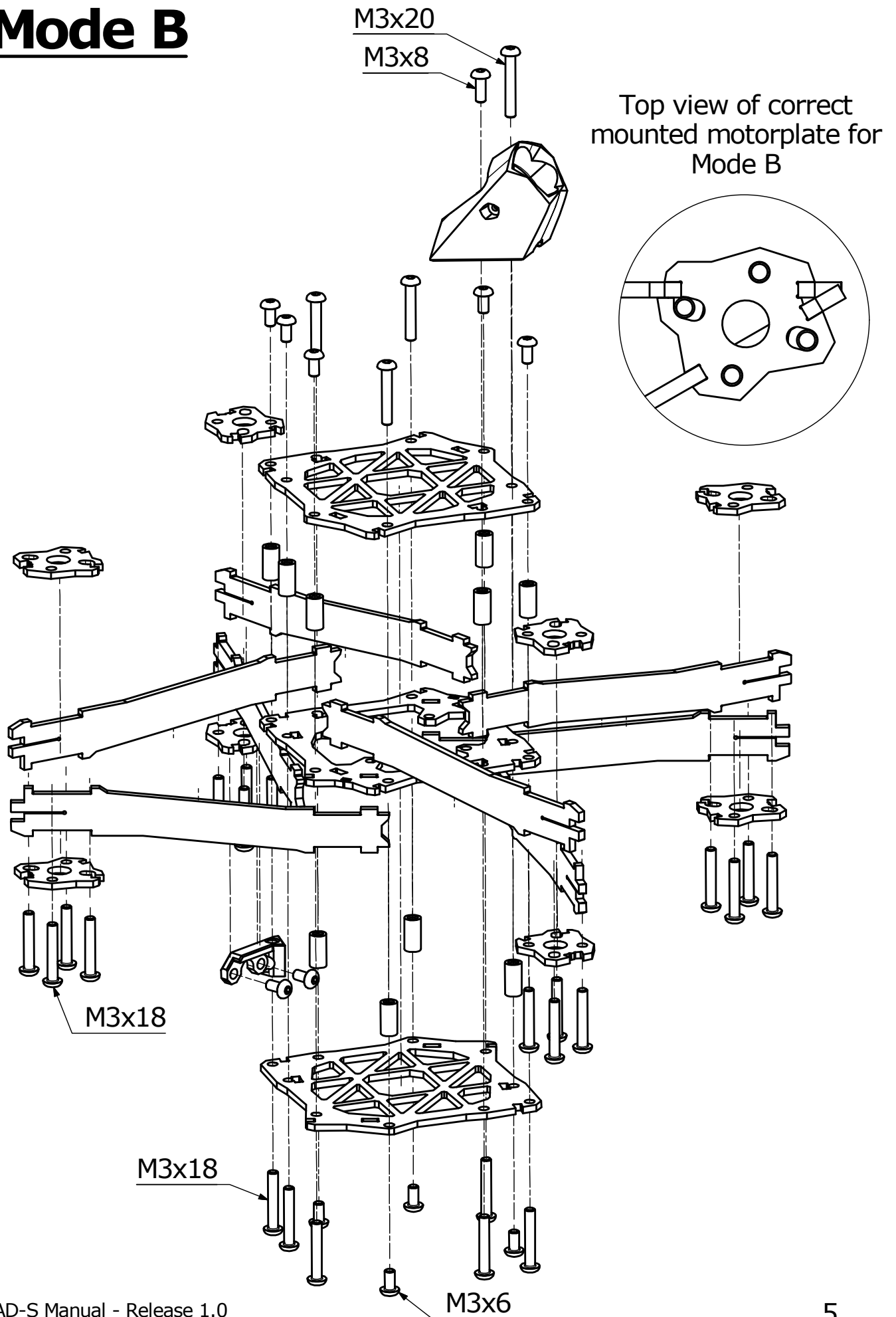

Step by step assembly instructions

Following pages show one example of how to build the MAD-S. The frame is compatible with most common drone racing parts. For this example following parts are shown as reference and are **NOT** included in MAD-S frame kit.

An animated version of this example can be found at madkwads.com

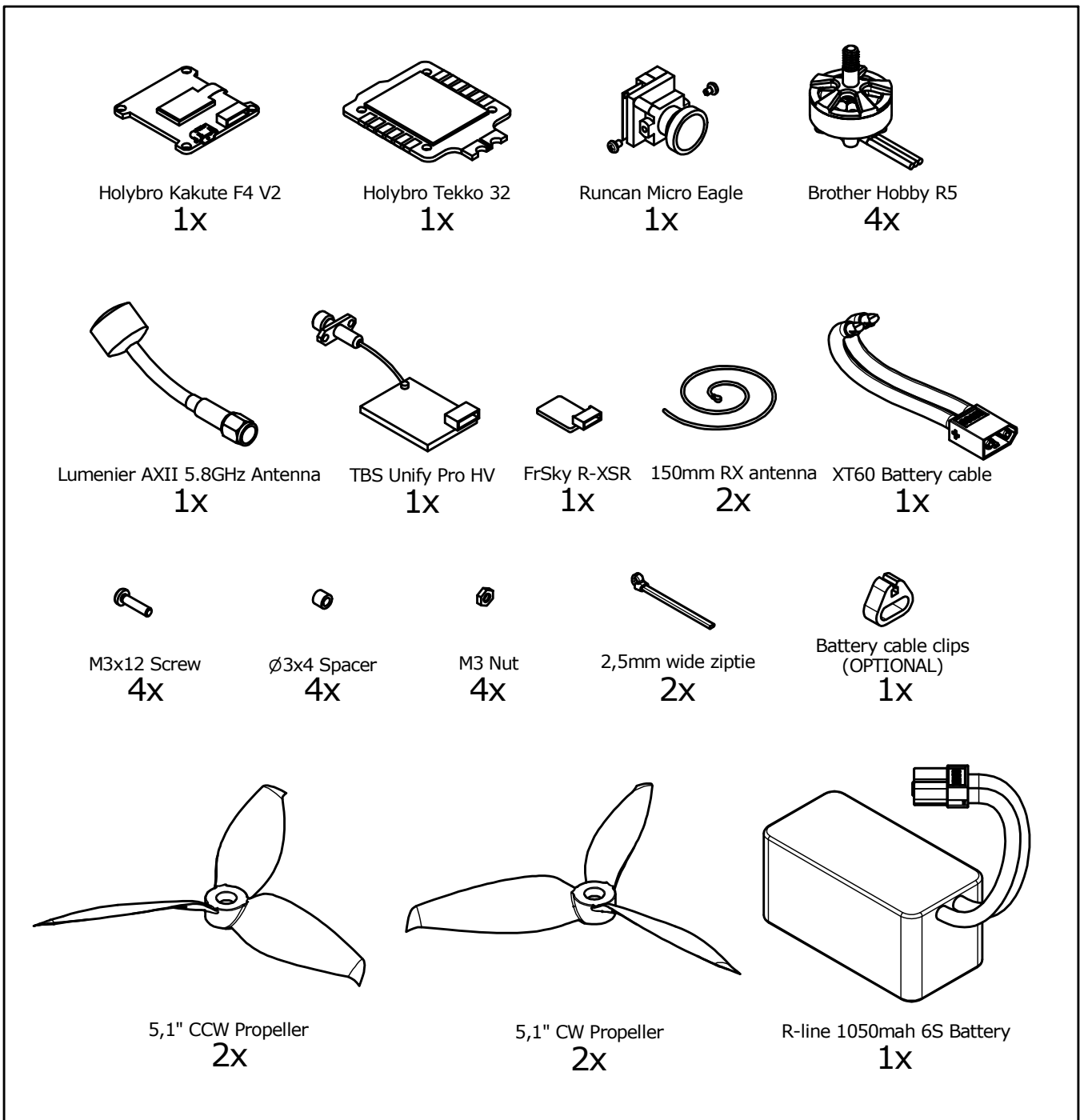

1

Mount FC and ESC to center plate

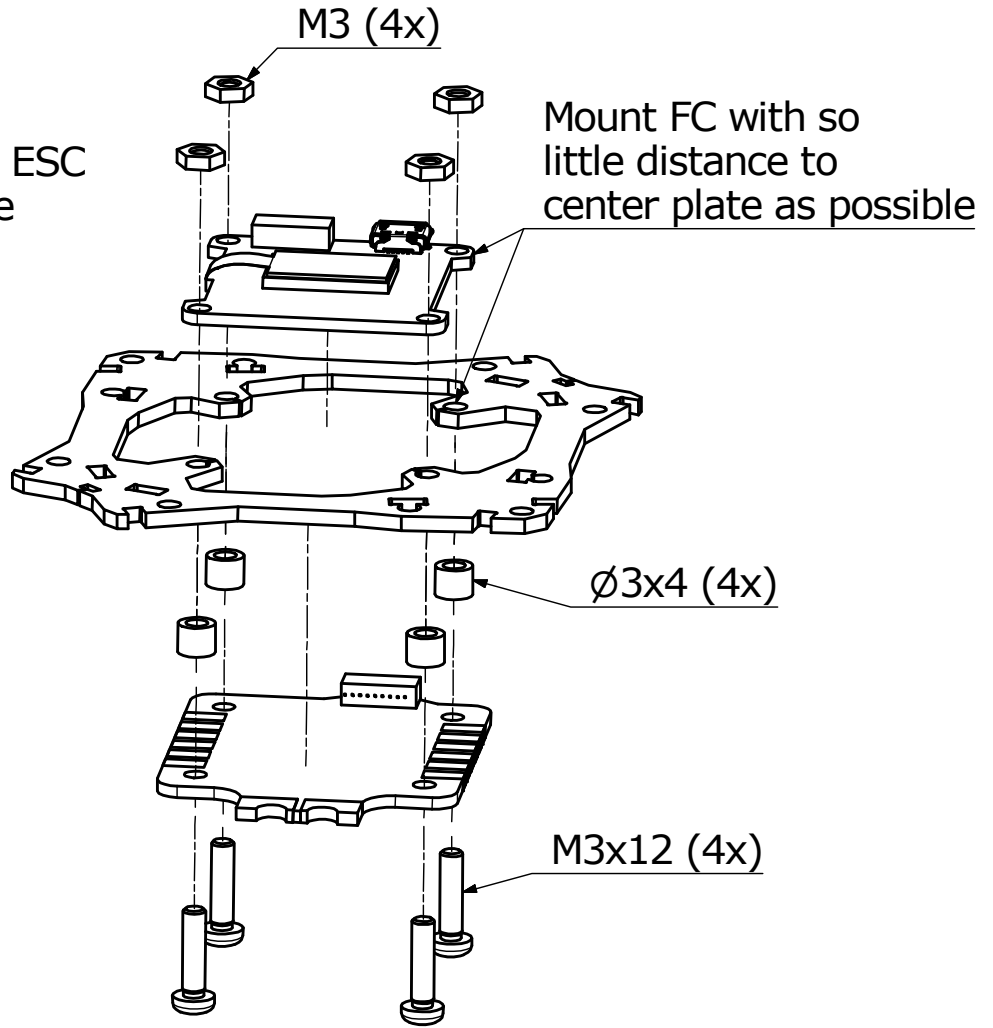

2

Temporarily pre-mount standoffs to bottom plate - these will be removed in step 13

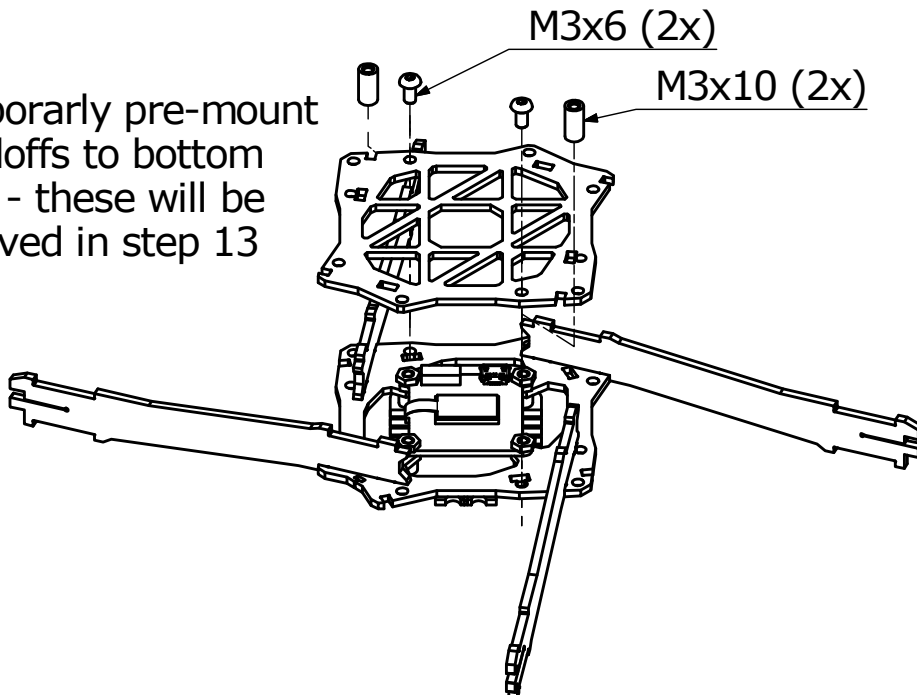

3

Temporarily mount bottom plate - it will be removed in step 13

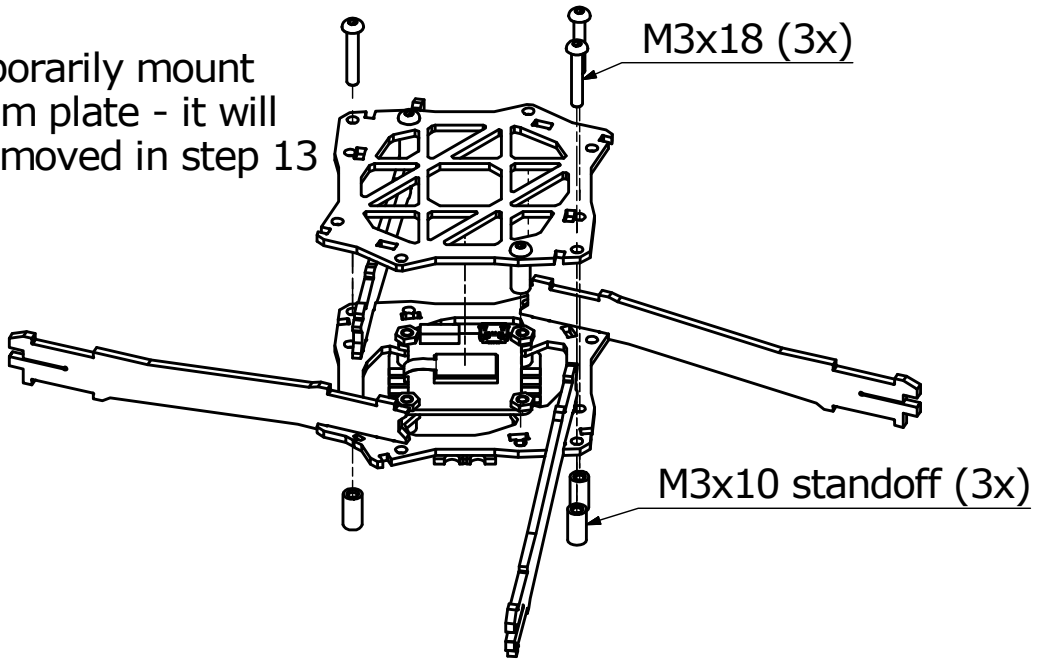

4

Double check that USB cable can be connected to FC

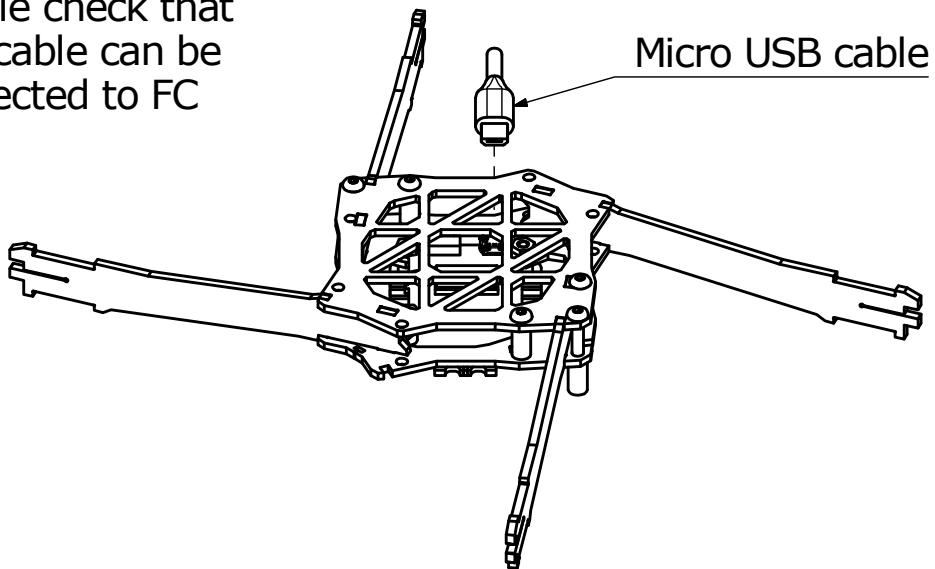

5

Mount motor

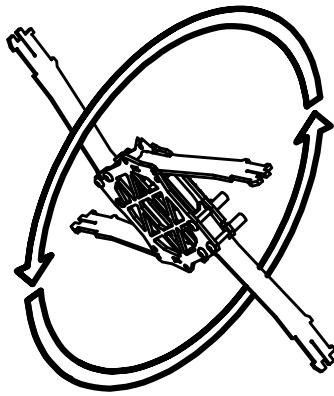

Top view of correct mounted motorplate for Mode A

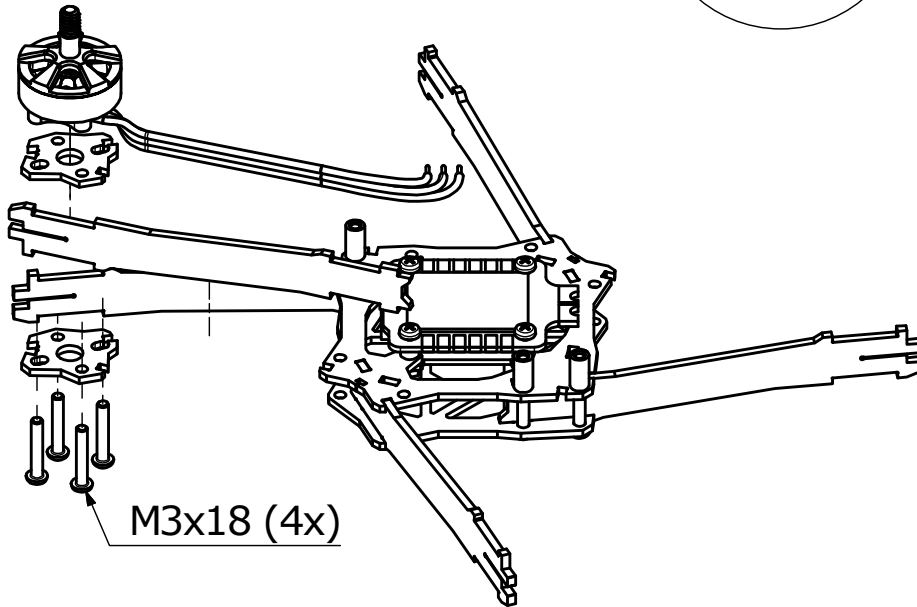
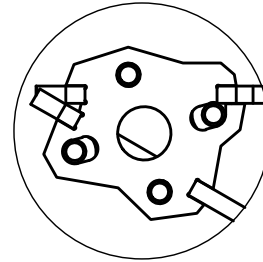

6

Repeat step 5 for each motor

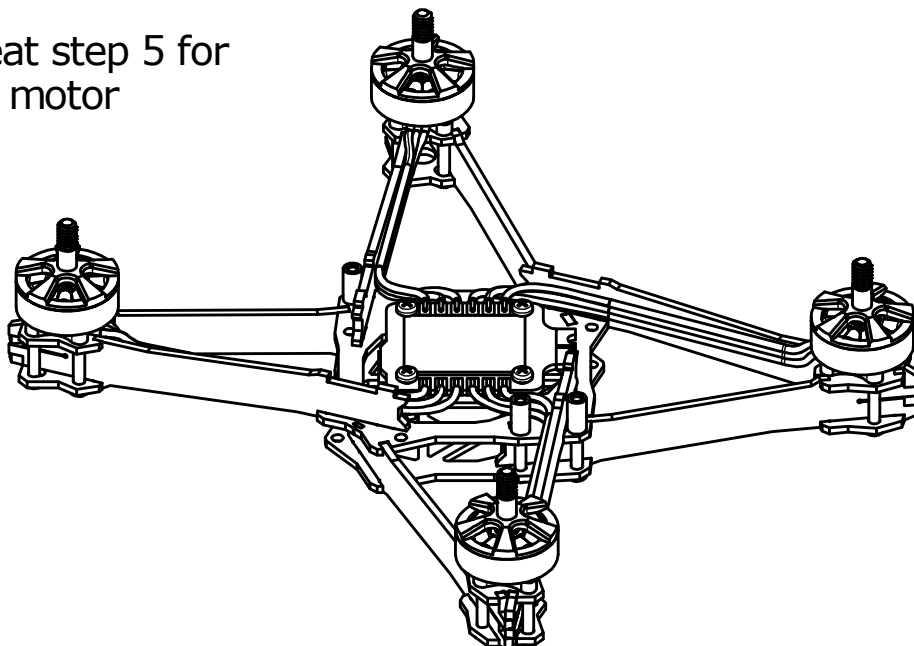

7

Solder motor and battery cables.
If battery clips are used - pull it over cable before soldering

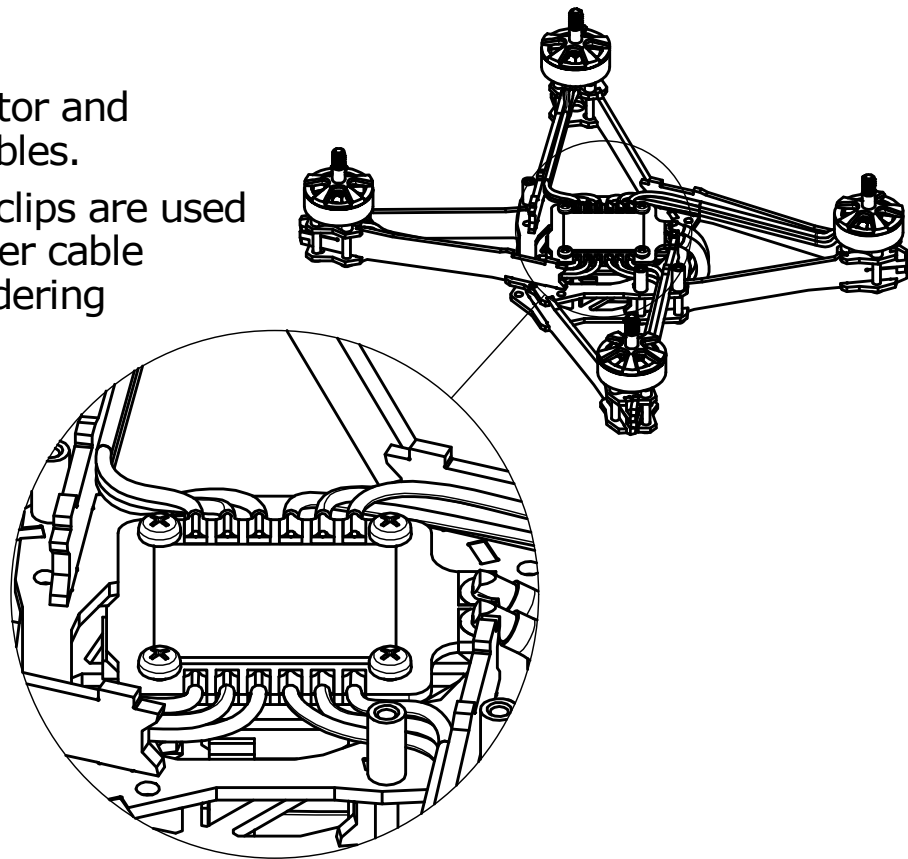

8

Pre-mount standoffs to top plate

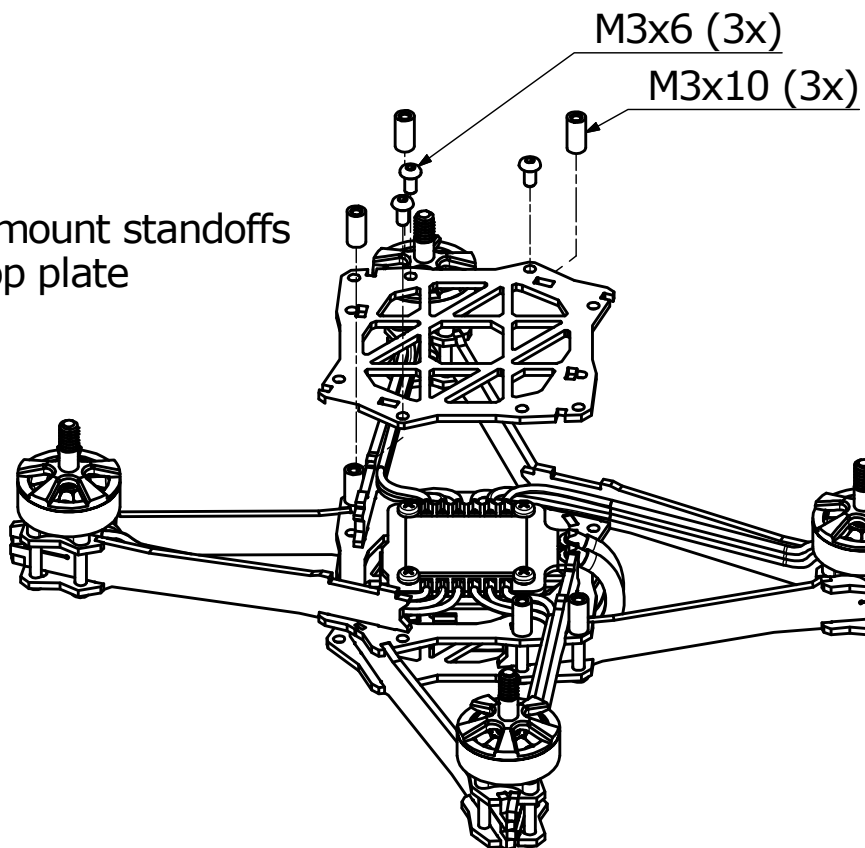

9

Mount battery straps to top plate **BEFORE** mounting plate

Metal catch facing forward

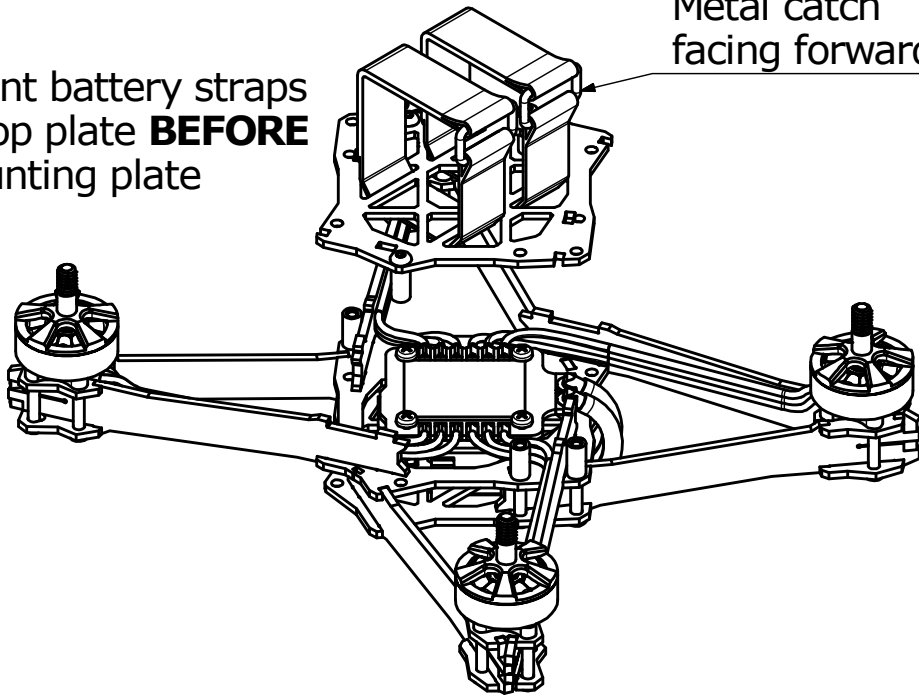

10

Mount top plate

M3x18 (1x)

M3x6 (2x)

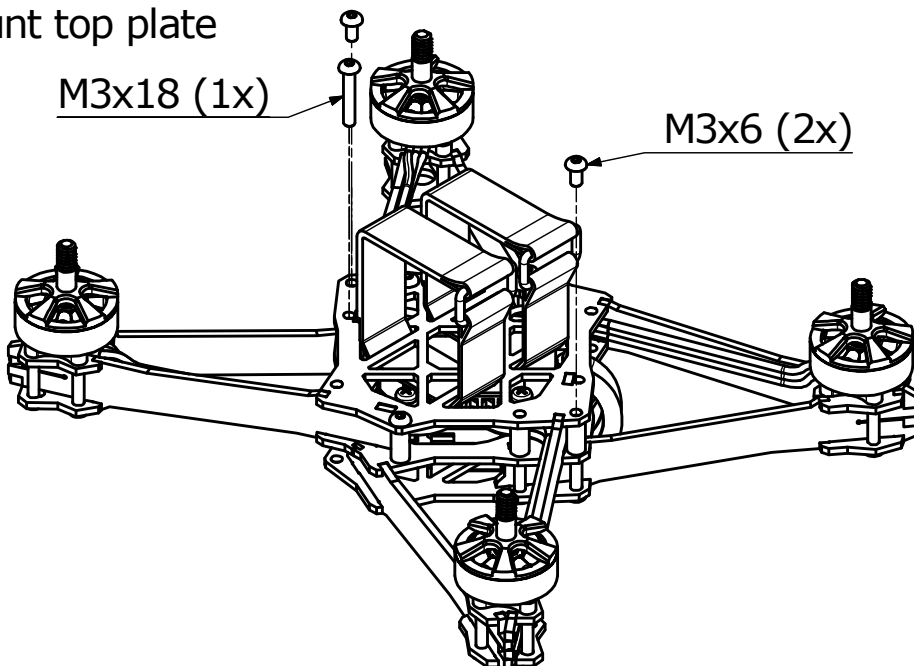

11

Mount camera bracket using screws with odd length and color

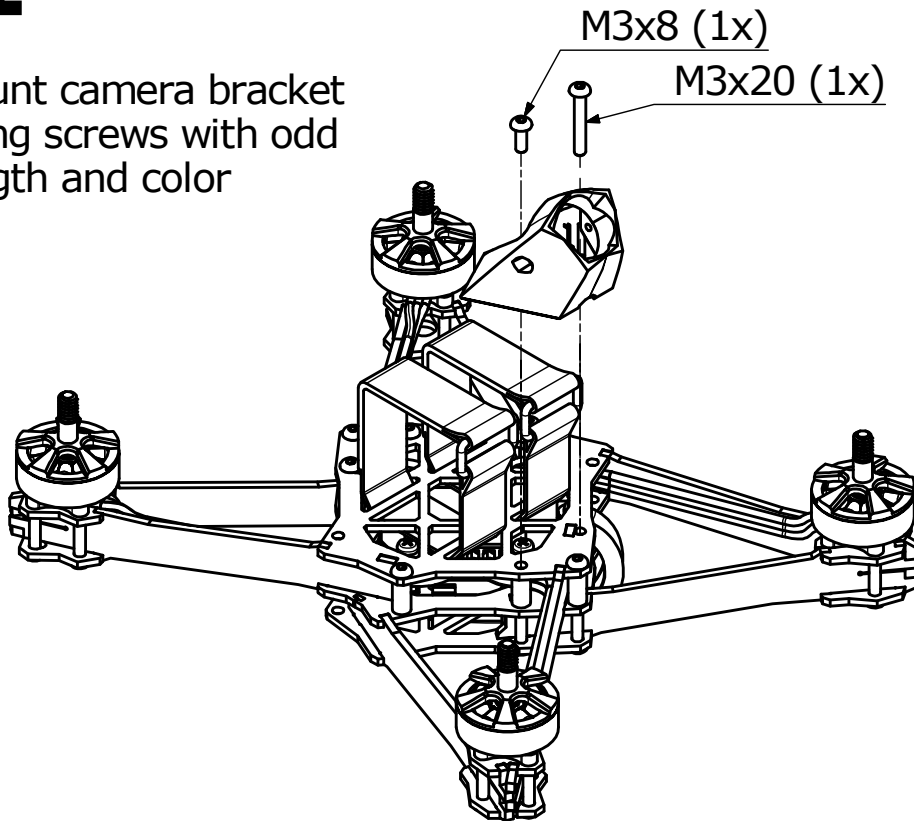

12

Mount camera using M2 screws supplied with camera

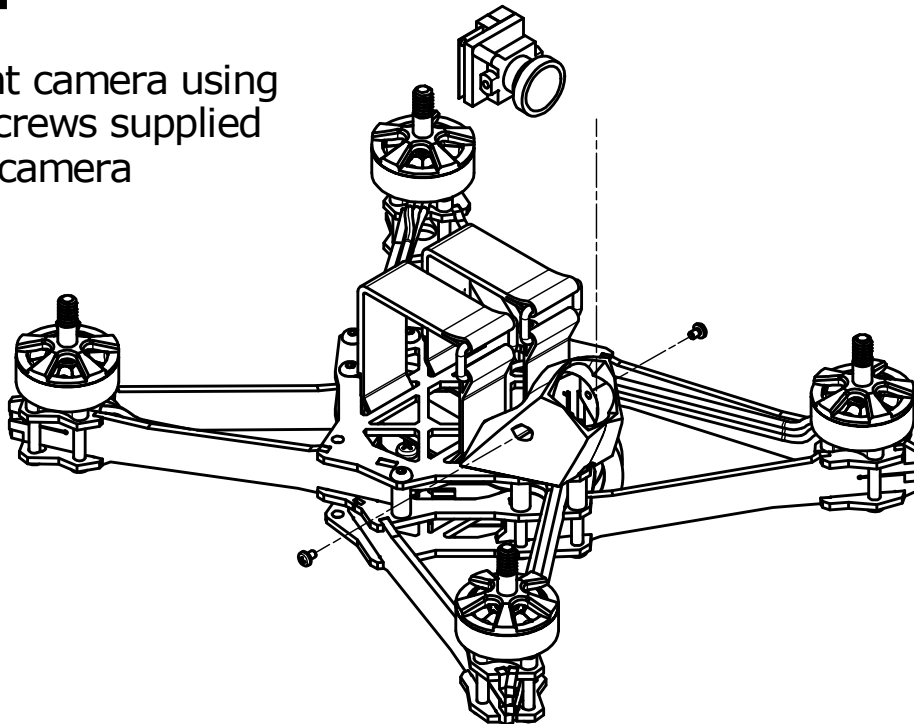

13

Unmount bottom plate

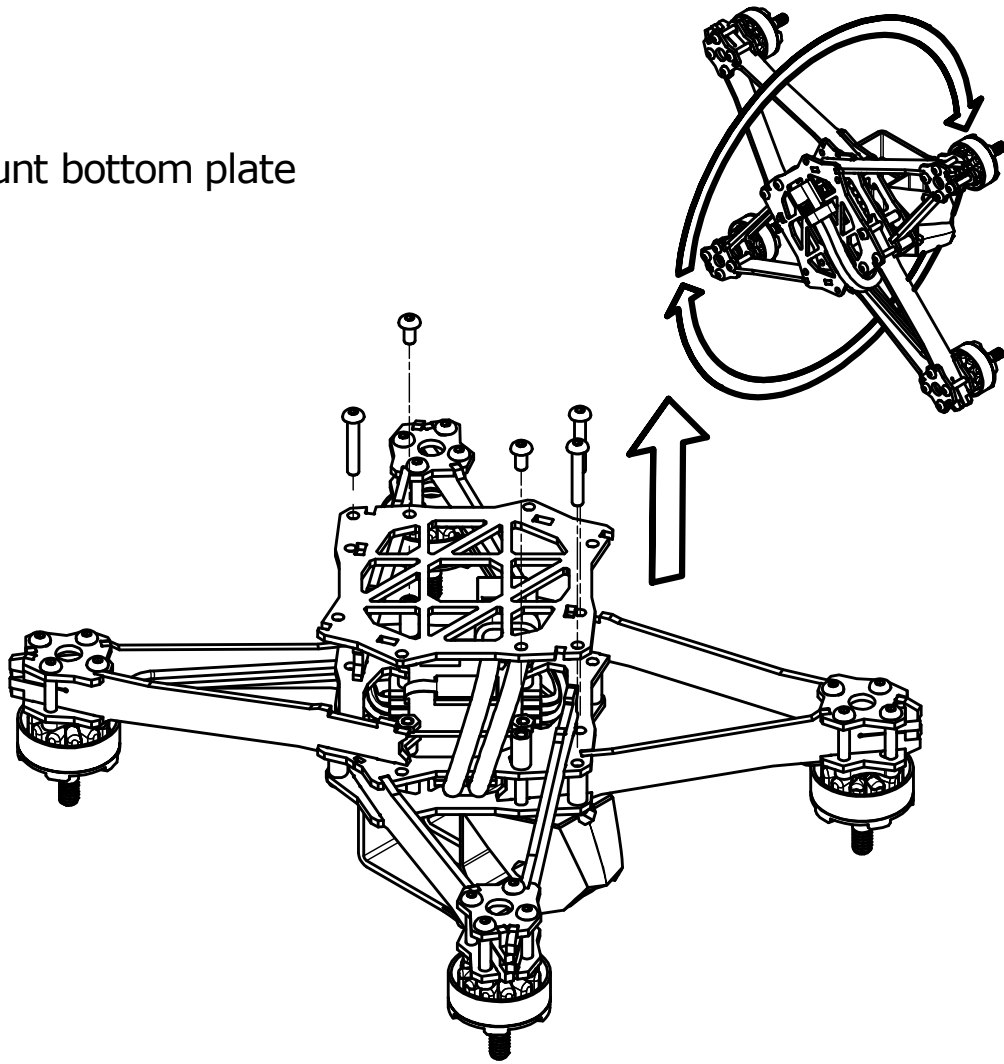

14

Install and connect RX and connect camera

zip tie antenna to motor plate when using 900Mhz RX

Holes for zip ties when using 2,4Ghz RX

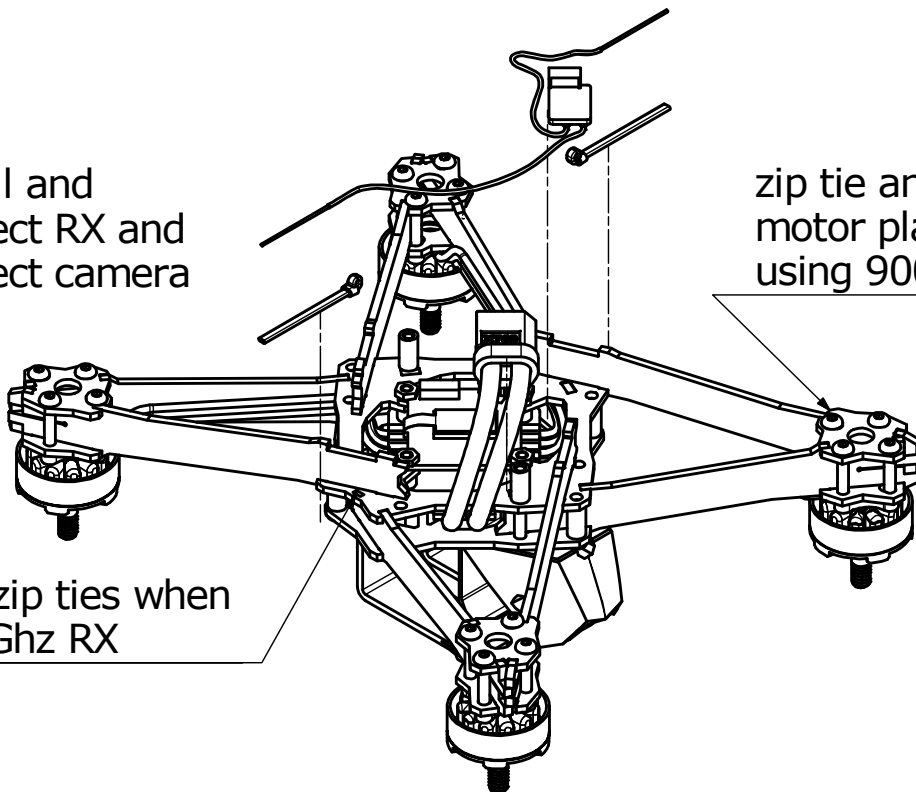

15

Pre-mount standoffs to bottom plate

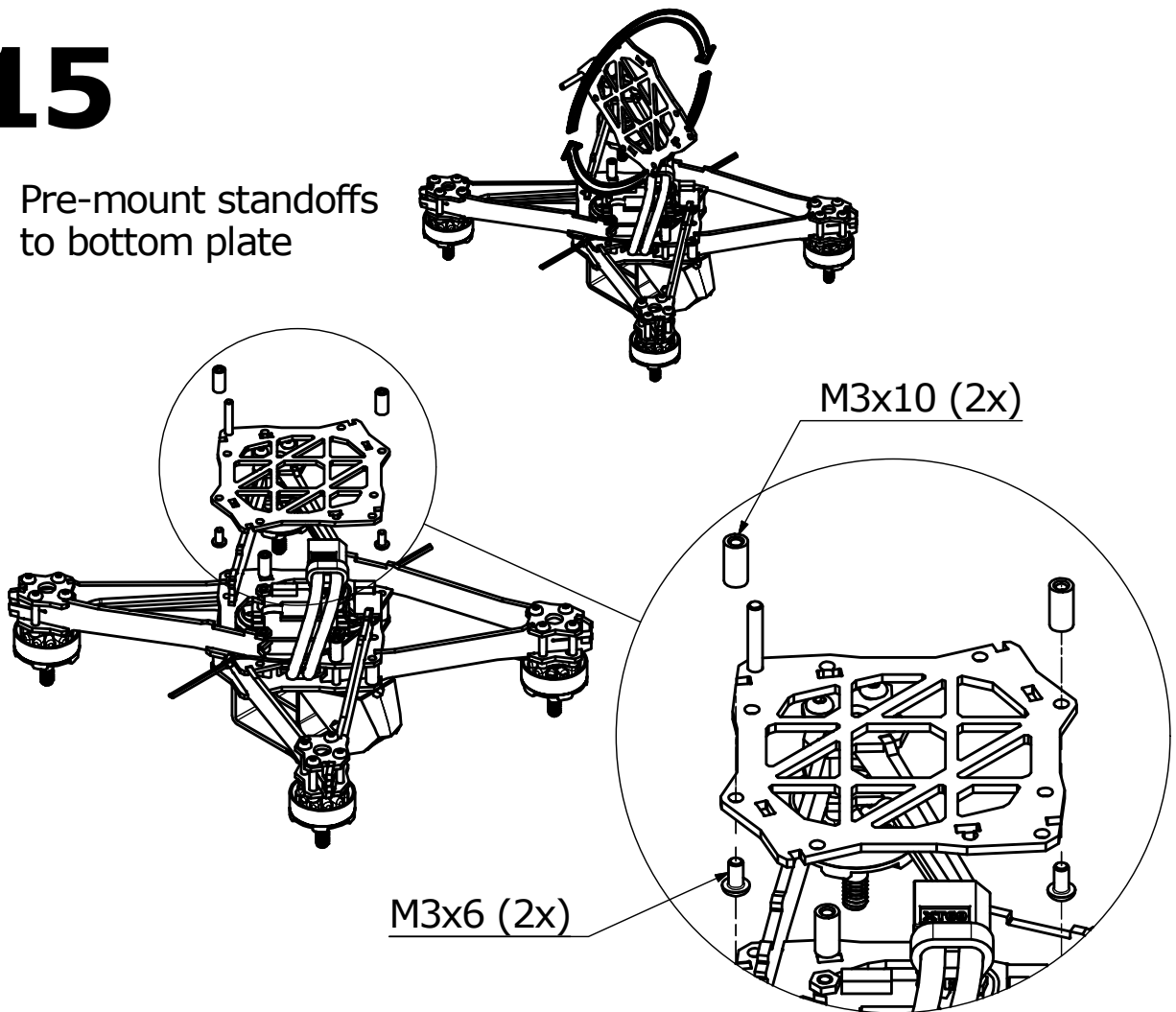

16

Install and connect VTX and antenna

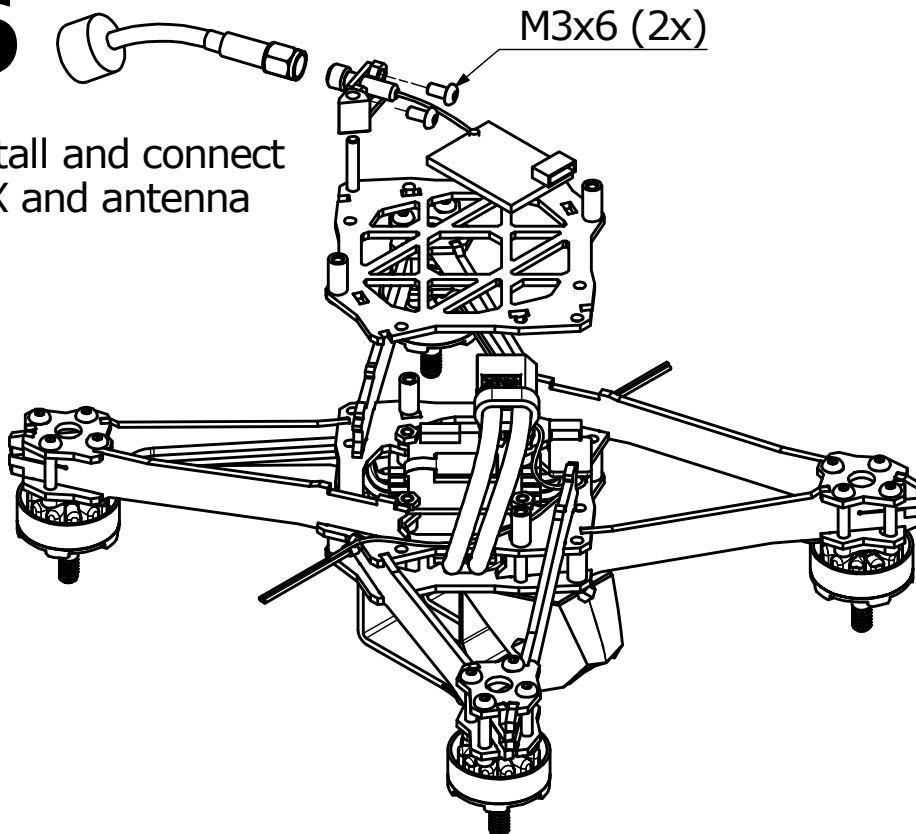

17

Mount bottom plate

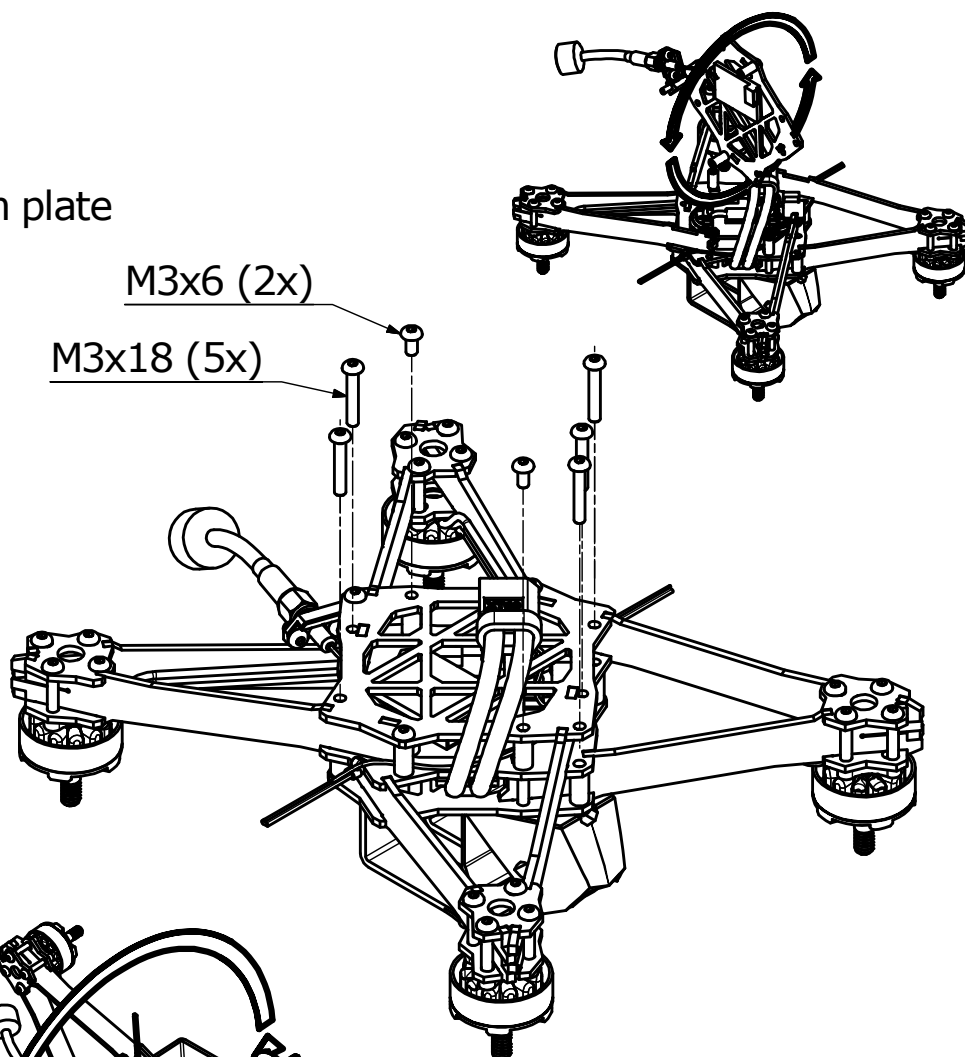

M3x6 (2x)

M3x18 (5x)

18

Mount screws in top plate

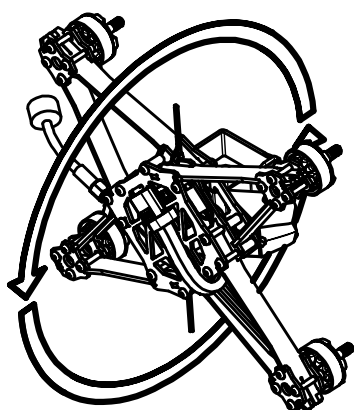

M3x18 (2x)

19

Check motor rotation direction and configure FC. Information about how to configure and tune MAD-S can be found at madkwads.com

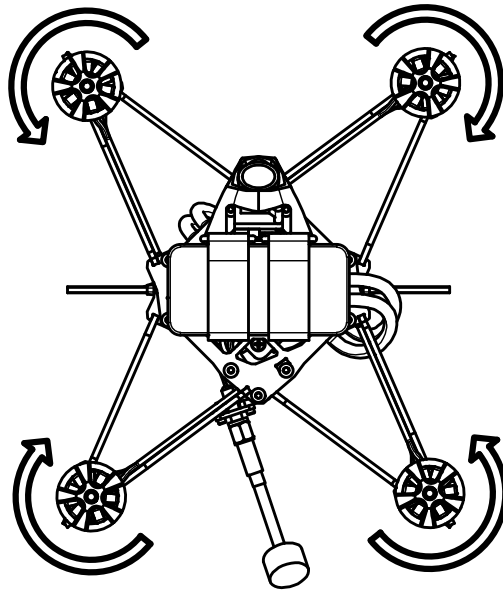

20

Install propellers and fly

